

Coil Window Spring Selection Guide 2010

3/4" Width Series

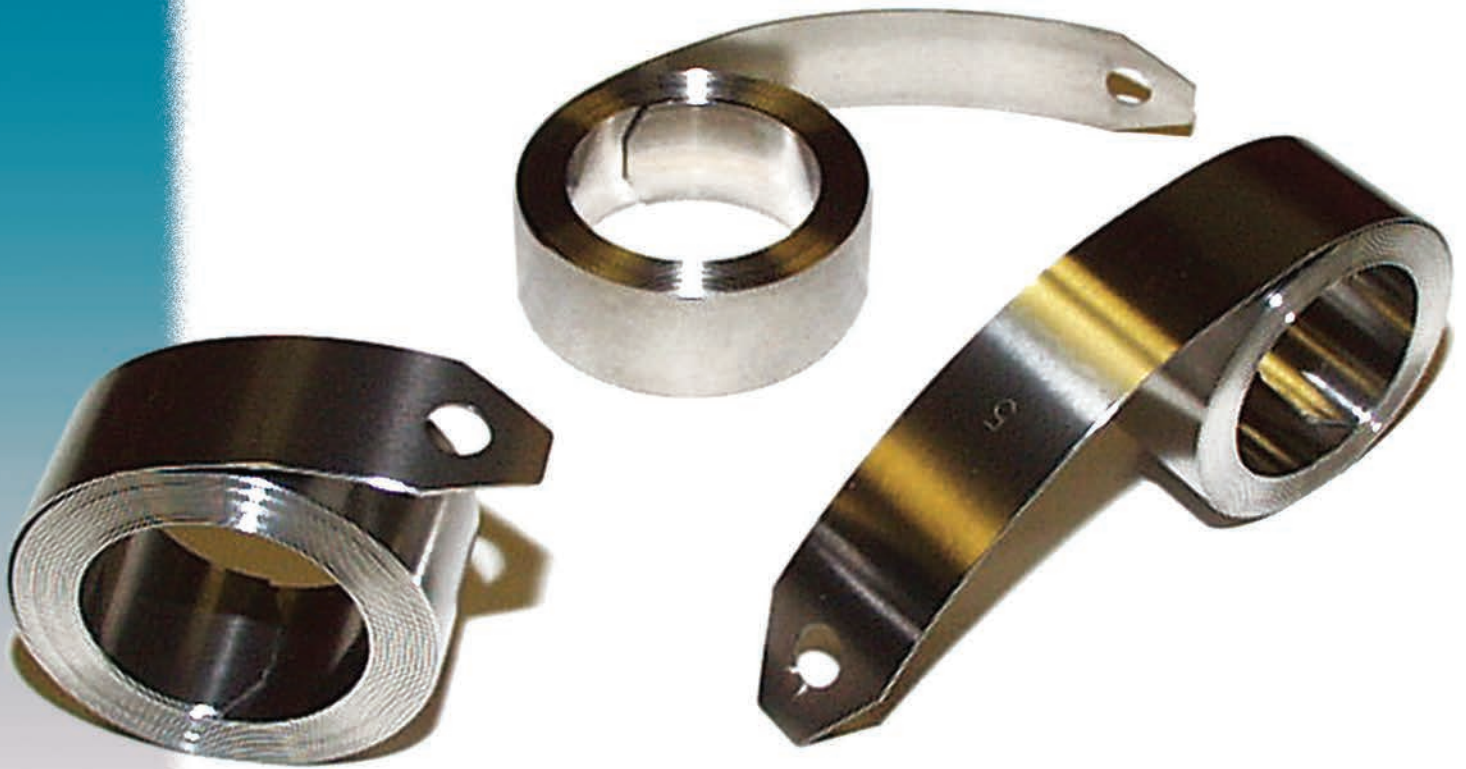

1 Spring Ave. • P.O. Box 885 • Lansdale, PA 19446
Phone 215-368-7700 • Fax 215-368-9019
www.springcompany.com • sales@springcompany.com

**JOHN
EVANS'
SONS** Est. 1850

SPRINGS MADE BETTER

John Evans' Sons, Inc.

Constant Force Window Balance Springs

3/4" width Coil Window Spring Selection Guide

These charts are a basic guideline, the actual weight and weather stripping friction should be taken into account for a final selection.

Window spring selection value (lifting force) shown is for one side of one sash.

Insulated Glass Weight Values:

- Double pane, single strength
 - 2.24 lb. per square foot
- Double pane, double strength
 - 3.24 lb. per square foot
- Triple pane, single strength
 - 3.56 lb. per square foot
- Triple pane, double strength
 - 4.9 lb. per square foot

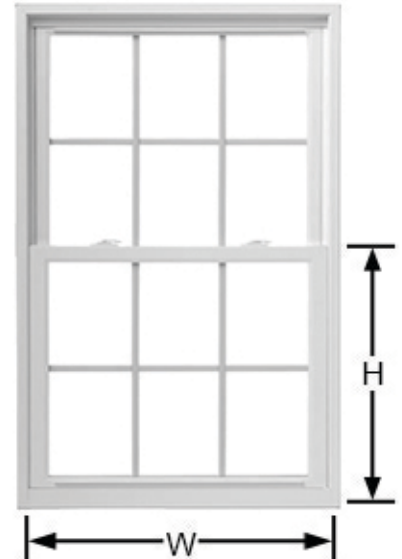

Evans' charts use the height and width of a single sash for all calculations.

How To Calculate

Example

Material: Double pane, single strength, insulated glass

Physical Dimensions: Height of sash: 29"

Width of sash: 26"

1. **Select proper chart** by glass construction & strength
For this example, the chart on pg. 3 will be used.
2. **Find the intersection** of sash height & width
 - go to height (29")
 - follow across to width, (26")
 - number 6 is the result
3. **Your solution** is (2) 6 lb. springs will be needed per sash
see illustration -right

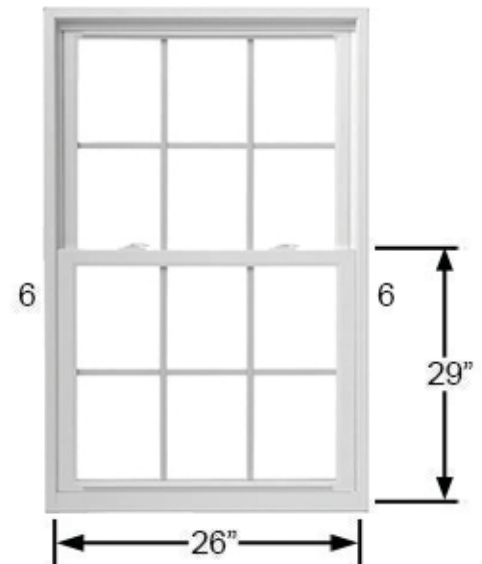

**JOHN
EVANS'
SONS** Est. 1850

SPRINGS MADE BETTER

John Evans' Sons, Inc.

3/4" Coil Spring Selection Guide

Chart Designation <i>(from pages 3 - 10)</i>	Coil Spring Selection
3	3 lb
4	4 lb
5	5 lb
6	6 lb
7	7 lb
8	8 lb
9	9 lb
10	10 lb
11	11 lb
12	6 lb + 6 lb
13	6 lb + 7 lb
14	7 lb + 7 lb
15	7 lb + 8 lb
16	8 lb + 8 lb
17	8 lb + 9 lb
18	9 lb + 9 lb
19	9 lb + 10 lb
20	10 lb + 10 lb
21	10 lb + 11 lb
22	11 lb + 11 lb
23	7 lb + 8 lb + 8 lb
24	8 lb + 8 lb + 8 lb
25	8 lb + 8 lb + 9 lb
26	8 lb + 9 lb + 9 lb
27	9 lb + 9 lb + 9 lb
28	9 lb + 9 lb + 10 lb
29	9 lb + 10 lb + 10 lb
30	10 lb + 10 lb + 10 lb
31	10 lb + 10 lb + 11 lb
32	10 lb + 11 lb + 11 lb
33	11 lb + 11 lb + 11 lb
34	8 lb + 8 lb + 9 lb + 9 lb
35	8 lb + 9 lb + 9 lb + 9 lb
36	9 lb + 9 lb + 9 lb + 9 lb
37	9 lb + 9 lb + 9 lb + 10 lb
38	9 lb + 9 lb + 10 lb + 10 lb
39	9 lb + 10 lb + 10 lb + 10 lb
40	10 lb + 10 lb + 10 lb + 10 lb
41	10 lb + 10 lb + 10 lb + 11 lb
42	10 lb + 10 lb + 11 lb + 11 lb
43	10 lb + 11 lb + 11 lb + 11 lb
44	11 lb + 11 lb + 11 lb + 11 lb

John Evans' Sons, Inc.
3/4" Coil Spring Selection Guide
Double Pane, Single Strength Insulated Glass

		Sash Width (in)																									
		10	12	14	16	18	20	22	24	26	28	30	32	34	36	38	40	42	44	46	48		50	52	54	56	
Sash Height (in)	9	3	3	3	3	3	3	3	3	3	3	3	3	3	3	3	3	3	3	3	3	4	4	4	4	9	
	10	3	3	3	3	3	3	3	3	3	3	3	3	3	3	3	3	3	3	3	4	4	4	4	10		
	11	3	3	3	3	3	3	3	3	3	3	3	3	3	3	3	4	4	4	4	4	4	5	5	5	11	
	12	3	3	3	3	3	3	3	3	3	3	3	3	3	3	4	4	4	4	4	4	5	5	5	5	12	
	13	3	3	3	3	3	3	3	3	3	3	3	3	4	4	4	4	4	5	5	5	5	5	6	6	13	
	14	3	3	3	3	3	3	3	3	3	3	3	4	4	4	4	4	5	5	5	5	6	6	6	6	14	
	15	3	3	3	3	3	3	3	3	3	3	4	4	4	4	5	5	5	5	5	6	6	6	6	7	15	
	16	3	3	3	3	3	3	3	3	3	4	4	4	4	5	5	5	5	6	6	6	6	7	7	7	16	
	17	3	3	3	3	3	3	3	3	4	4	4	4	5	5	5	5	6	6	6	6	7	7	7	8	17	
	18	3	3	3	3	3	3	3	3	4	4	4	4	5	5	5	5	6	6	6	7	7	7	8	8	18	
	19	3	3	3	3	3	3	3	4	4	4	4	5	5	5	5	6	6	6	7	7	7	8	8	8	19	
	20	3	3	3	3	3	3	4	4	4	4	5	5	5	6	6	6	7	7	7	8	8	8	9	9	20	
	21	3	3	3	3	3	3	4	4	4	5	5	5	6	6	6	7	7	7	8	8	8	9	9	9	21	
	22	3	3	3	3	3	4	4	4	5	5	5	6	6	6	7	7	7	8	8	8	9	9	10	10	22	
	23	3	3	3	3	3	4	4	4	5	5	5	6	6	7	7	7	8	8	8	9	9	9	10	10	23	
	24	3	3	3	3	3	4	4	5	5	5	6	6	6	7	7	8	8	8	9	9	9	10	10	11	24	
	25	3	3	3	3	4	4	4	5	5	6	6	6	7	7	7	8	8	9	9	9	10	10	11	11	25	
	26	3	3	3	3	4	4	5	5	5	6	6	7	7	7	8	8	9	9	9	10	10	11	11	11	26	
	27	3	3	3	3	4	4	5	5	6	6	6	7	7	8	8	8	9	9	10	10	11	11	12	12	27	
	28	3	3	3	4	4	4	5	5	6	6	7	7	8	8	8	9	9	10	10	11	11	11	12	12	28	
	29	3	3	3	4	4	5	5	6	6	6	7	7	8	8	9	9	10	10	11	11	11	12	12	13	29	
	30	3	3	3	4	4	5	5	6	6	7	7	8	8	8	9	9	10	10	11	11	11	12	12	13	30	
	31	3	3	3	4	4	5	5	6	6	7	7	8	8	9	9	10	10	11	11	12	12	13	13	14	31	
	32	3	3	4	4	5	5	6	6	7	7	8	8	9	9	10	10	11	11	12	12	13	13	14	14	32	
	33	3	3	4	4	5	5	6	6	7	7	8	8	9	9	10	10	11	11	12	12	13	13	14	14	33	
	34	3	3	4	4	5	5	6	6	7	8	8	9	9	10	10	11	11	12	12	13	13	14	14	15	34	
	35	3	3	4	4	5	6	6	7	7	8	8	9	9	10	10	11	12	12	13	13	14	14	15	15	35	
	36	3	3	4	5	5	6	6	7	7	8	8	9	10	10	11	11	12	12	13	14	14	15	15	16	36	
	37	3	4	4	5	5	6	6	7	8	8	9	9	10	10	11	12	12	13	13	14	14	15	16	16	37	
	38	3	4	4	5	5	6	7	7	8	8	9	10	10	11	11	12	13	13	14	14	15	15	16	17	38	
	39	3	4	4	5	6	6	7	7	8	9	9	10	10	11	12	12	13	13	14	15	15	16	16	17	39	
	40	3	4	4	5	6	6	7	8	8	9	9	10	11	11	12	13	13	14	14	15	16	16	17	18	40	
	41	3	4	5	5	6	6	7	8	8	9	10	10	11	12	12	13	13	14	14	15	15	16	17	18	41	
	42	3	4	5	5	6	7	7	8	9	9	10	11	11	12	13	13	14	14	15	16	16	17	18	18	42	
	43	3	4	5	5	6	7	7	8	9	9	10	11	11	12	13	13	14	15	15	16	17	17	18	19	43	
	44	4	4	5	6	6	7	8	8	9	10	10	11	12	12	13	14	14	15	16	17	17	18	19	19	44	
	45	4	4	5	6	6	7	8	8	9	10	11	11	12	13	13	14	15	15	16	17	18	18	19	20	45	
	46	4	4	5	6	7	7	8	9	9	10	11	12	12	13	14	14	15	16	17	17	18	19	19	20	46	
	47	4	4	5	6	7	7	8	9	10	10	11	12	13	13	14	15	15	16	17	18	18	19	20	21	47	
	48	4	5	5	6	7	8	8	9	10	11	11	12	13	14	14	15	16	17	17	18	19	20	20	21	48	
	49	4	5	5	6	7	8	8	9	10	11	12	12	13	14	15	15	16	17	18	18	19	20	21	21	49	
	50	4	5	6	6	7	8	9	9	10	11	12	13	13	14	15	16	16	17	18	19	20	20	21	22	50	
	51	4	5	6	6	7	8	9	10	10	11	12	13	14	14	15	16	17	18	18	19	20	21	22	22	51	
	52	4	5	6	7	7	8	9	10	11	11	12	13	14	15	15	16	17	18	19	20	20	21	22	23	52	
	53	4	5	6	7	8	8	9	10	11	12	12	13	14	15	16	17	17	18	19	20	21	22	22	23	53	
	54	4	5	6	7	8	8	9	10	11	12	13	14	14	15	16	17	18	19	19	20	21	22	23	24	54	
	55	4	5	6	7	8	9	10	10	11	12	13	14	15	15	16	17	18	19	20	21	21	22	23	24	55	
	56	4	5	6	7	8	9	10	11	11	12	13	14	15	16	17	18	18	19	20	21	22	23	24	24	56	
	57	5	5	6	7	8	9	10	11	12	13	13	14	15	16	17	18	19	20	21	21	22	23	24	25	57	
	58	5	6	6	7	8	9	10	11	12	13	14	15	15	16	17	18	19	20	21	22	23	24	24	25	58	
	59	5	6	7	7	8	9	10	11	12	13	14	15	16	17	18	18	19	20	21	22	23	24	25	26	59	
			10	12	14	16	18	20	22	24	26	28	30	32	34	36	38	40	42	44	46	48	50	52	54	56	

**John Evans' Sons, Inc.
 3/4" Coil Spring Selection Guide
 Triple Pane, Single Strength Insulated Glass**

		Sash Width (in)																																	
		11	12	13	14	15	16	17	18	19	20	21	22	23	24	25	26	27	28	29	30	31	32	33	34										
Sash Height(in)	9	3	3	3	3	3	3	3	3	3	3	3	3	3	3	3	3	3	3	3	3	4	4	4	4	4	4	4	9						
	10	3	3	3	3	3	3	3	3	3	3	3	3	3	3	3	3	3	4	4	4	4	4	4	4	4	4	10							
	11	3	3	3	3	3	3	3	3	3	3	3	3	3	3	3	4	4	4	4	4	4	4	4	4	5	5	11							
	12	3	3	3	3	3	3	3	3	3	3	3	3	4	4	4	4	4	4	4	4	5	5	5	5	5	5	12							
	13	3	3	3	3	3	3	3	3	3	3	3	4	4	4	4	4	4	5	5	5	5	5	5	5	5	6	13							
	14	3	3	3	3	3	3	3	3	3	4	4	4	4	4	4	5	5	5	5	5	5	6	6	6	6	6	14							
	15	3	3	3	3	3	3	3	3	4	4	4	4	4	5	5	5	5	5	5	6	6	6	6	6	6	6	15							
	16	3	3	3	3	3	3	4	4	4	4	4	5	5	5	5	5	6	6	6	6	6	6	6	7	7	16								
	17	3	3	3	3	3	4	4	4	4	4	5	5	5	5	5	6	6	6	6	6	6	7	7	7	7	17								
	18	3	3	3	3	4	4	4	4	4	5	5	5	5	5	6	6	6	6	6	7	7	7	7	7	8	18								
	19	3	3	3	4	4	4	4	4	5	5	5	5	6	6	6	6	6	6	7	7	7	7	8	8	8	19								
	20	3	3	4	4	4	4	4	5	5	5	5	6	6	6	6	7	7	7	7	8	8	8	8	9	9	20								
	21	3	3	4	4	4	5	5	5	5	6	6	6	6	7	7	7	7	7	8	8	8	8	9	9	9	21								
	22	3	4	4	4	4	5	5	5	6	6	6	6	7	7	7	7	8	8	8	9	9	9	9	9	9	22								
	23	3	4	4	4	5	5	5	6	6	6	6	7	7	7	7	8	8	8	9	9	9	9	9	10	10	23								
	24	3	4	4	4	5	5	5	6	6	6	7	7	7	8	8	8	8	9	9	9	9	10	10	10	10	24								
	25	3	4	4	5	5	5	6	6	6	7	7	7	8	8	8	8	9	9	9	9	10	10	10	11	11	25								
	26	4	4	4	5	5	5	6	6	6	7	7	7	8	8	8	9	9	9	9	10	10	10	11	11	11	26								
	27	4	4	4	5	5	6	6	6	7	7	7	8	8	8	9	9	9	9	10	10	10	11	11	11	11	27								
	28	4	4	5	5	5	6	6	6	7	7	7	8	8	8	9	9	9	10	10	10	11	11	12	12	12	28								
	29	4	4	5	5	5	6	6	7	7	7	8	8	8	9	9	9	10	10	10	11	11	12	12	12	12	29								
	30	4	5	5	5	6	6	6	7	7	8	8	8	9	9	9	10	10	10	11	11	12	12	12	13	13	30								
	31	4	5	5	5	6	6	7	7	7	8	8	9	9	9	10	10	10	11	11	12	12	12	13	13	13	31								
	32	4	5	5	6	6	6	7	7	8	8	8	9	9	10	10	10	11	11	12	12	12	13	13	14	14	32								
	33	5	5	5	6	6	7	7	7	8	8	9	9	9	10	10	11	11	12	12	12	13	13	14	14	14	33								
	34	5	5	6	6	6	7	7	8	8	9	9	9	10	10	11	11	11	12	12	13	13	14	14	14	14	34								
	35	5	5	6	6	7	7	7	8	8	9	9	10	10	10	11	11	12	12	13	13	14	14	14	15	15	35								
	36	5	5	6	6	7	7	8	8	9	9	9	10	10	11	11	12	12	13	13	13	14	14	15	15	15	36								
	37	5	6	6	7	7	7	8	8	9	9	10	10	11	11	12	12	12	13	13	14	14	15	15	16	16	37								
	38	5	6	6	7	7	8	8	9	9	9	10	10	11	11	12	12	13	13	14	14	15	15	16	16	16	38								
	39	5	6	6	7	7	8	8	9	9	10	10	11	11	12	12	13	13	14	14	15	15	16	16	16	16	39								
	40	6	6	7	7	8	8	9	9	9	10	10	11	11	12	12	13	13	14	14	15	15	16	16	17	17	40								
	41	6	6	7	7	8	8	9	9	10	10	11	11	12	12	13	13	14	14	15	15	16	16	17	17	17	41								
	42	6	6	7	7	8	8	9	9	10	10	11	12	12	13	13	14	14	15	15	16	16	17	17	18	18	42								
43	6	6	7	8	8	9	9	10	10	11	11	12	12	13	13	14	14	15	16	16	17	17	18	18	18	43									
44	6	7	7	8	8	9	9	10	10	11	12	12	13	13	14	14	15	15	16	16	17	18	18	19	19	44									
45	6	7	7	8	8	9	10	10	11	11	12	12	13	13	14	15	15	16	16	17	17	18	18	19	19	45									
46	6	7	7	8	9	9	10	10	11	11	12	13	13	14	14	15	15	16	17	17	18	18	19	19	19	46									
47	6	7	8	8	9	9	10	11	11	12	12	13	13	14	15	15	16	16	17	18	18	19	19	20	20	47									
48	7	7	8	8	9	10	10	11	11	12	13	13	14	14	15	16	16	17	17	18	18	19	20	20	20	48									
49	7	7	8	9	9	10	10	11	12	12	13	13	14	15	15	16	16	17	18	18	19	19	20	21	21	49									
50	7	8	8	9	9	10	11	11	12	12	13	14	14	15	16	16	17	17	18	19	19	20	20	21	21	50									
51	7	8	8	9	10	10	11	11	12	13	13	14	15	15	16	16	17	18	18	19	20	20	21	22	22	51									
52	7	8	8	9	10	10	11	12	12	13	14	14	15	16	16	17	17	18	19	19	20	21	21	22	22	52									
53	7	8	9	9	10	11	11	12	13	13	14	15	15	16	16	17	18	18	19	20	20	21	22	22	22	53									
54	7	8	9	9	10	11	11	12	13	13	14	15	15	16	17	17	18	19	19	20	21	21	22	23	23	54									
55	8	8	9	10	10	11	12	12	13	14	14	15	16	16	17	18	18	19	20	20	21	22	23	23	23	55									
56	8	8	9	10	10	11	12	13	13	14	15	15	16	17	17	18	19	19	20	21	22	22	23	24	24	56									
57	8	9	9	10	11	11	12	13	13	14	15	16	16	17	18	18	19	20	21	21	22	23	23	24	24	57									

John Evans' Sons, Inc.
3/4" Coil Spring Selection Guide
Triple Pane, Double Strength Insulated Glass

		Sash Width (in)																								
		35	36	37	38	39	40	41	42	43	44	45	46	47	48	49	50	51	52	53	54	55	56	57	58	
Sash Height (in)	9	5	6	6	6	6	6	6	7	7	7	7	7	7	7	7	8	8	8	8	8	9	9	9	9	9
	10	6	6	6	7	7	7	7	7	7	8	8	8	8	8	8	9	9	9	9	9	9	10	10	10	10
	11	7	7	7	7	7	8	8	8	8	8	9	9	9	9	9	9	10	10	10	10	10	10	11	11	11
	12	7	7	8	8	8	8	8	8	9	9	9	9	9	9	10	10	10	10	11	11	11	11	11	12	12
	13	8	8	8	9	9	9	9	9	9	10	10	10	10	10	11	11	11	11	12	12	12	12	12	13	13
	14	8	9	9	9	9	10	10	10	10	10	11	11	11	11	12	12	12	12	13	13	13	13	13	14	14
	15	9	9	10	10	10	10	11	11	11	11	11	12	12	12	12	13	13	13	13	14	14	14	14	15	15
	16	10	10	10	10	11	11	11	11	12	12	12	12	13	13	13	13	14	14	14	15	15	15	15	16	16
	17	10	11	11	11	11	12	12	12	12	13	13	13	13	14	14	14	15	15	15	15	16	16	16	17	17
	18	11	11	11	12	12	12	13	13	13	14	14	14	14	15	15	15	16	16	16	17	17	17	17	18	18
	19	11	12	12	12	13	13	13	13	14	14	14	15	15	15	16	16	16	17	17	17	18	18	18	19	19
	20	12	12	13	13	13	14	14	14	15	15	15	16	16	16	17	17	17	18	18	18	19	19	19	20	20
	21	13	13	13	14	14	14	15	15	15	16	16	17	17	17	18	18	18	19	19	19	20	20	20	21	21
	22	13	14	14	14	15	15	15	16	16	17	17	17	18	18	18	19	19	20	20	20	21	21	21	22	22
	23	14	14	15	15	15	16	16	17	17	17	18	18	18	19	19	20	20	20	21	21	22	22	22	23	23
	24	14	15	15	16	16	16	17	17	18	18	18	19	19	20	20	21	21	21	22	22	23	23	23	24	24
	25	15	15	16	16	17	17	18	18	18	19	19	20	20	21	21	21	22	22	23	23	23	24	24	25	25
	26	16	16	16	17	17	18	18	19	19	20	20	20	21	21	22	22	23	23	24	24	24	25	25	26	26
	27	16	17	17	18	18	18	19	19	20	20	21	21	22	22	23	23	24	24	24	25	25	26	26	27	27
	28	17	17	18	18	19	19	20	20	21	21	22	22	23	23	24	24	25	25	26	26	27	27	28	28	28
	29	17	18	18	19	19	20	20	21	21	22	22	23	23	24	24	25	25	26	26	27	27	28	28	29	29
	30	18	18	19	19	20	21	21	22	22	23	23	24	24	25	25	26	26	27	27	28	28	29	29	30	30
	31	19	19	20	20	21	21	22	22	23	23	24	24	25	25	26	26	27	27	28	28	29	29	30	31	31
	32	19	20	20	21	21	22	22	23	24	24	25	25	26	26	27	27	28	28	29	29	30	31	31	32	32
	33	20	20	21	21	22	23	23	24	24	25	25	26	26	27	28	28	29	29	30	30	31	32	32	33	33
	34	20	21	22	22	23	23	24	24	25	26	26	27	27	28	28	29	30	30	31	31	32	32	33	34	34
	35	21	22	22	23	23	24	25	25	26	26	27	27	28	29	29	30	30	31	32	32	33	33	34	35	35
	36	22	22	23	23	24	25	25	26	26	27	28	28	29	29	30	31	31	32	33	33	34	34	35	36	36
	37	22	23	23	24	25	25	26	27	27	28	28	29	30	30	31	32	32	33	33	34	35	35	36	37	37
	38	23	23	24	25	25	26	27	27	28	29	29	30	30	31	32	32	33	34	34	35	36	36	37	38	38
	39	23	24	25	25	26	27	27	28	29	29	30	31	31	32	33	33	34	35	35	36	37	37	38	39	39
	40	24	25	25	26	27	27	28	29	29	30	31	31	32	33	33	34	35	35	36	37	38	38	39	40	40
	41	25	25	26	27	27	28	29	29	30	31	31	32	33	34	34	35	36	36	37	38	38	39	40	41	41
	42	25	26	27	27	28	29	29	30	31	32	32	33	34	34	35	36	37	37	38	39	39	40	41	42	42
	43	26	26	27	28	29	29	30	31	32	32	33	34	34	35	36	37	37	38	39	40	40	41	42	43	43
	44	26	27	28	29	29	30	31	32	32	33	34	35	35	36	37	38	38	39	40	41	41	42	43	44	44
	45	27	28	28	29	30	31	31	32	33	34	35	35	36	37	38	38	39	40	41	41	42	43	44		45
	46	27	28	29	30	31	31	32	33	34	35	35	36	37	38	38	39	40	41	42	42	43	44			46
	47	28	29	30	30	31	32	33	34	34	35	36	37	38	38	39	40	41	42	42	43	44				47
	48	29	29	30	31	32	33	34	34	35	36	37	38	38	39	40	41	42	43	43						48
	49	29	30	31	32	33	33	34	35	36	37	38	38	39	40	41	42	43	43							49
	50	30	31	32	32	33	34	35	36	37	38	38	39	40	41	42	43	43								50
	51	30	31	32	33	34	35	36	37	37	38	39	40	41	42	43	43									51
	52	31	32	33	34	35	35	36	37	38	39	40	41	42	43	43										52
	53	32	33	33	34	35	36	37	38	39	40	41	42	42	43											53
	54	32	33	34	35	36	37	38	39	40	41	41	42	43												54
	55	33	34	35	36	37	38	38	39	40	41	42	43	44												55
	56	33	34	35	36	37	38	39	40	41	42	43	44													56
	57	34	35	36	37	38	39	40	41	42	43	44														57