

Security for P.O.P. Displays -

Spring reels with retractable jacketed stainless steel cables are widely used in point-of-purchase displays to prevent theft and/or misplacement of items on display.

John Evans' Sons, Inc. offers a variety of standard products and additional optional features to accommodate the requirements of many different customers and products. Our compact units are often the best or the only solution when space is limited.

Our standard products and lists of options are below and continued on the reverse side. Please contact us for discussion of your requirements.



ER Series (Enclosed Reel)

Standard Specifications:

- ER04 3 oz. nominal retracting load @ nominal maximum deflection (60").
- ER06 7 oz. nominal retracting load @ nominal maximum deflection (50").
- ER08 12 oz. nominal retracting load @ nominal maximum deflection (40").
- Color - natural nylon (translucent white).
- Cable is .018" stainless steel, nylon coated to .024", minimum breaking strength - 40 lbs.
- Cable end terminal is eyelet for #8 screw (.175").
- Includes our company label on side.

RETRIEVER

Standard specifications:

- 3 oz. nominal retracting load @ nominal maximum deflection (42").
- Color - black.
- Cable is .027" stainless steel, black nylon coated to .034", minimum breaking strength - 90 lbs.
- Cable end terminal is eyelet for #8 screw (.175").
- Includes our company label on side.

MER Series (Miniature Enclosed Reel)

Standard specifications:

- 4 oz. nominal retracting load @ nominal maximum deflection (26").
- Color - black.
- Cable is .018" stainless steel, clear nylon coated to .024", minimum breaking strength - 40 lbs.
- Cable end terminal is eyelet for #8 screw (.175").
- Includes our company label on side.

See reverse side for options.

John Evans' Sons, Inc.

An ISO 9001:2000 Company

1 Spring Ave.

P.O. Box 885

Lansdale, PA 19446

Phone: 215-368-7700

Fax: 215-368-9019

sales@springcompany.com

www.springcompany.com



ENCLOSED REEL (ER)



RETRIEVER



MINIATURE ENCLOSED REEL (MER)

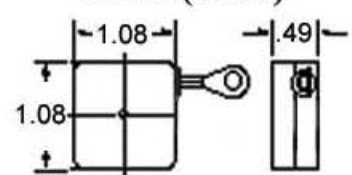
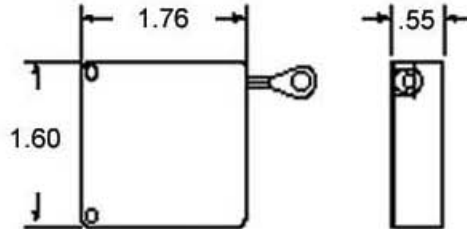
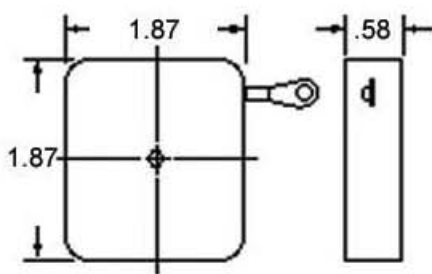

Options List I: (readily available depending on quantity)

Cable End Attachment Methods:

- Formed loop.
- Plastic attachment plate (with white adhesive tape or no tape).
- Stainless steel attachment plate with adhesive tape (3/4" sq. or 3/4" x 1-3/4").
- Two plastic attachment plates - one attached and one sliding.
- Pigtail using any end terminal configuration.

ER Reel Attachment Methods:

- Adhesive pad. Color - white.
- Hook & loop fastener pad. Color - black.
- Plastic backing plate - mounted vertically or horizontally for left or right hand pull. (ER series only)

Options List II: (requires longer lead time and possibly a minimum order quantity)

- Color of reel/retriever.
- Length of cable (limited to maximum deflection in standard specifications).
- Adhesive pad - unusual dimensions or colors other than white.
- Hook & loop fastener pad. Colors other than black.

Customized Products:

- Load characteristics (pulling force) other than standard.
- Cable other than standard.
- End attachments other than listed above.

John Evans' Sons, Inc.
 An ISO 9001:2000 Company

1 Spring Ave.
 P.O. Box 885
 Lansdale, PA 19446

Phone: 215-368-7700
 Fax: 215-368-9019

sales@springcompany.com
 www.springcompany.com